

AN ORDINANCE AMENDING KING COUNTY DISTRICTING (ZONING) RESOLUTION NO. 18801, AS AMENDED BY AUTHORIZING A PLANNED UNIT DEVELOPMENT ON CERTAIN PROPERTY.

WHEREAS PLA-MOR MOBILE HOME ESTATES, Div. #1 has petitioned King County requesting approval of a planned unit development on property described in said petition and all legal requirements have been performed; and

WHEREAS the Department of Planning has transmitted to the King County Council, King County, Washington, a copy of the Department's findings and action recommending approval of this planned unit development;

NOW, THEREFORE BE IT ORDAINED that the King County Council does hereby adopt the findings and recommendation of the Department of Planning as its own and does hereby approve the final plans for Planned Unit Development as shown in Exhibit(s) DD attached hereto and made a part hereof as located hereon and legally described herein which lies within Section (s) 33 Township 22 Range 6 E.W.M., on Area Map(s) W-45 a part of the District (Zoning) Map.

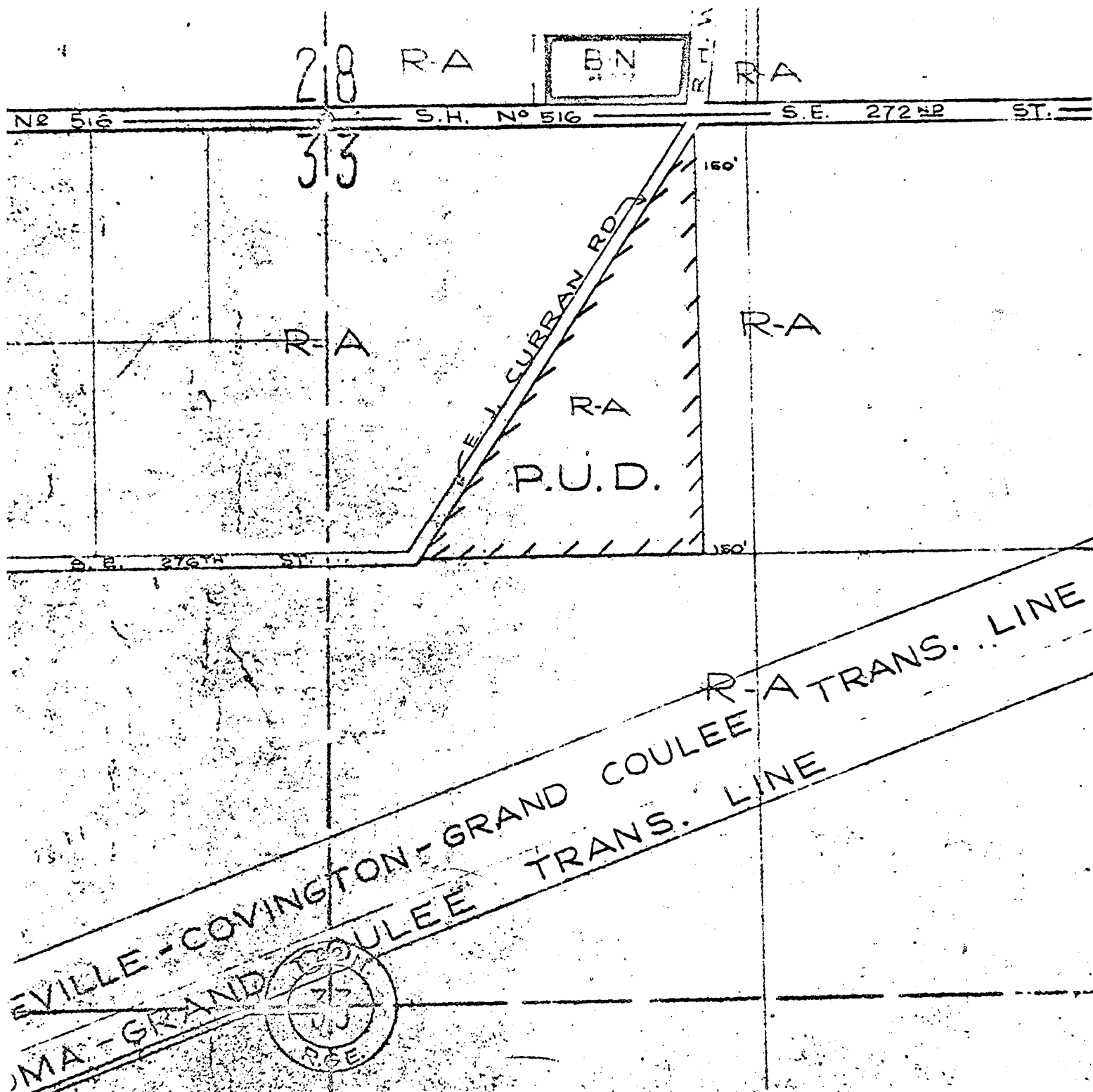

AREA RECLASSIFIED BY THIS RESOLUTION

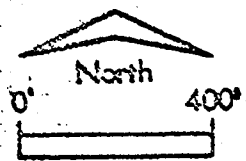

LEGAL DESCRIPTION:

That portion of the northwest quarter of the northeast quarter of Section 33, Township 22 North, Range 6 East, W. M., lying easterly of E. J. Curran Road. Less County roads.

ATTEST:
RALPH R. STENDER

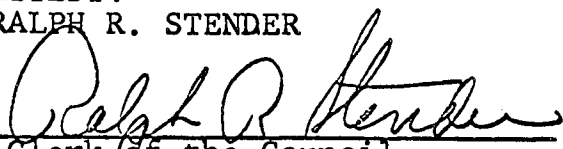
Clerk of the Council

PASSED this 9th day of June, 1969.

KING COUNTY COUNCIL
KING COUNTY, WASHINGTON

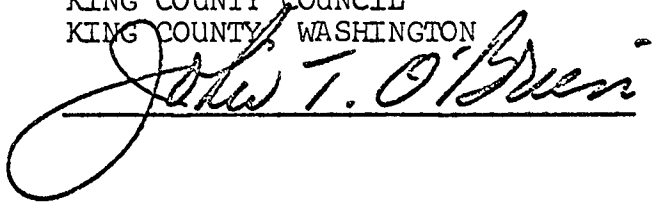

ATTEST:
RALPH R. STENDER
Clerk of the King County Council

A P P R O V E D

Date 6-12-69

JOHN H. SPELLMAN
County Executive

ORDINANCE READINGS

1st May 19, 1969
2nd June 2, 1969
3rd June 9, 1969
Effective Date June 19, 1969